

Molteni & C

505— NICOLA GALLIZIA 2012

1—
15



505 is a carrier shoulder system with an extensive range of modular furnishings in 7 widths, 3 depths and 9 heights, designed to house books and a television. The finishes, matt or glossy lacquered or woods and glasses can be mixed and matched to obtain different solutions in order to answer to the modern needs. As well as the standard hinged opening with handle, 505 also has hinged doors, internal and external drawers, flap doors with pressure opening, sliding doors and vertical sliding doors. To complete the system, there are multimedia compartments, different worktops, but also the possibility to compose set of containers, placed directly on the floor or hung just above floor level.

DATASHEET

REGISTERED
DESIGN

IX.2015

molteni.it

Dimensions in millimeters and inches. The right to discontinue and make changes is reserved. This information is based on the latest product information available at the time of printing.

MODULARITY

Measurements

Wall to wall widths:

315 - 473 - 630 - 945 - 1260 - 1417 - 1890 + 28 mm for end piece
12 3/8" - 18 5/8" - 24 7/8" - 37 1/4" - 49 5/8" - 55 3/4" - 74 3/8" + 1 1/8"

Heights:

397 - 717 - 1037 - 1357 - 1677 - 1997 - 2317 - 2637 - 2957 mm
15 5/8" - 28 1/4" - 40 7/8" - 53 3/8" - 66" - 78 5/8" - 91 1/4" - 103 7/8" - 116 3/8"

Structure depth:

304 - 400 - 540 mm (12" - 15 3/4" - 21 1/4")

Depth with pressure opening th 40 (1 5/8") / glass doors with shaped profile:

348 - 444 - 584 mm (13 3/4" - 17 1/2" - 23")

Depth with pressure opening or handle th 22 (7/8"):

330 - 426 - 566 mm (13" - 16 3/4" - 22 1/4")

Depth with glass pressure opening th 5 (1/4"):

313 - 409 - 549 mm (12 3/8" - 16 1/8" - 21 5/8")

Notes

A minimum extra height space of 30 mm (1 1/8") is required for installation purposes; the same applies for the width if placed in a niche. Width, height, depth reductions are made with an interval of 32 mm (1 1/4").

The minimum width is 315 mm (12 3/8"), therefore no reductions is foreseen for units of 315 mm (12 3/8").

No reduction possible for:

Internal and external drawers

Sliding doors

Glass hinged doors

Vertical sliding doors

Flap doors th 40 (1 5/8") and th 22 (7/8")

Hinged doors th 40 (1 5/8")

TV compartment D 400 (15 3/4")

Heights and depth of the units resting on the floor

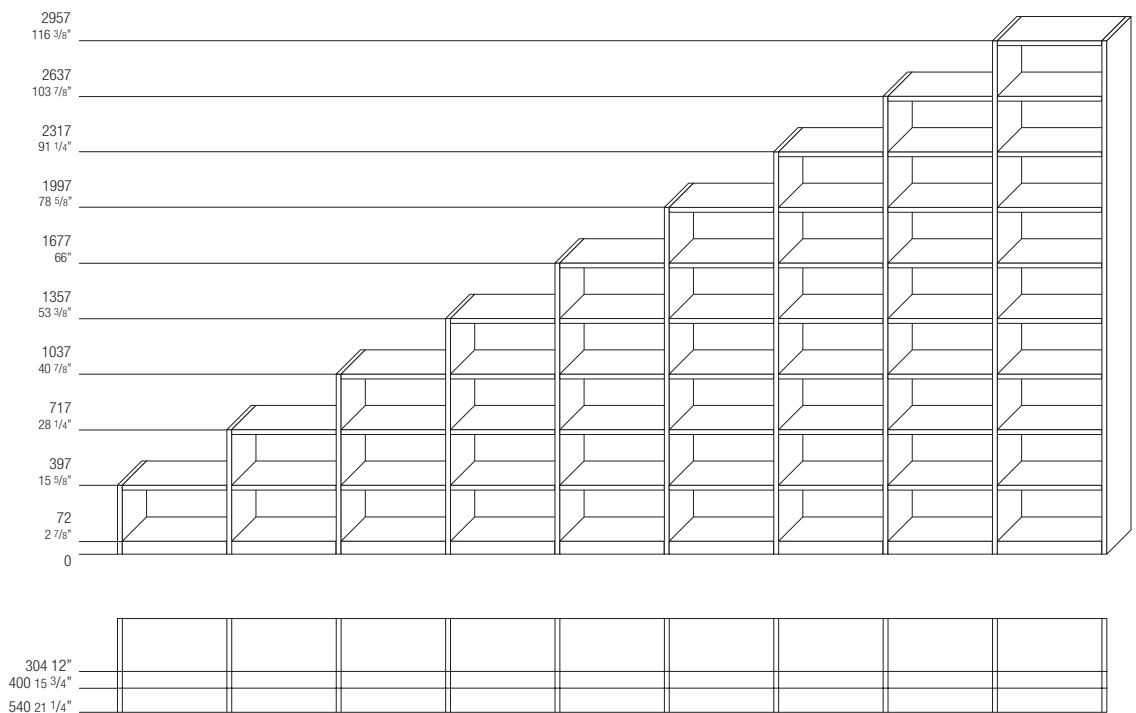

DATASHEET

REGISTERED
DESIGN

IX.2015

FINISHES

Wood grain

Pressure opening th 40

- HORIZONTAL GRAIN for vertical sliding doors, drawers and flap doors
- HORIZONTAL AND VERTICAL GRAIN for hinged and sliding doors

Pressure opening th 22

- HORIZONTAL GRAIN for drawers and flap doors
- VERTICAL GRAIN for hinged doors

Handle opening th. 22

- HORIZONTAL GRAIN for drawers
- VERTICAL GRAIN for hinged doors

Handle

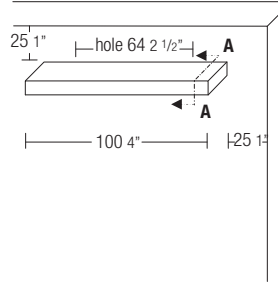

type B

handle opening th 22 (7/8")
(always horizontally positioned).
Upon request can be mounted on a vertical sliding door

section A-A

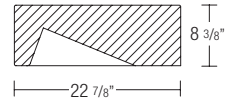

finishes:

- shiny chrome
- black chrome
- pewter colour

finishes	matt lacquer colours	glossy lacquer colours	woods	special woods	transparent glass	coloured glass	coloured etched glass	shiny aluminium/black chrome/pewter colour
components								
structure and plinth								
bridges								
backs								
rear finishing panels								
internal drawer units								
door opening th. 40 (hinged/sliding/flap/vertical sliding)								
doors/external drawers with handle or pressure opening th. 22								
glass doors with shaped profile	trim							
	glass					hinged	sliding	sliding
doors/external drawers with pressure opening th. 5								
shelves								
tops								
central finishing tops th. 40								
backs for TV								

colours

Matt lacquer

- BC chalk white
- AV ivory
- PE pearl
- DN dune
- PL platinum
- PB lead
- NE black
- BO bordeaux
- AT anthracite
- SE mustard
- SI silica
- DO dolomite grey
- AL clay
- MK moka
- CM caramel
- CZ light blue grey
- SA sand
- RU ruby
- CI cadmium

Glossy lacquer

- BC chalk white
- PE pearl
- DN dune
- PL platinum
- PB lead
- NE black
- BO bordeaux
- AT anthracite
- SE mustard
- SI silica
- DO dolomite grey
- AL clay
- MK moka
- CM caramel
- CZ light blue grey
- SA sand
- RU ruby
- CI cadmium

Woods

- EU eucalyptus
- RG grey oak
- RN black oak

Special woods

- OC light elm
- OS dark elm

Coloured glass

- BC chalk white
- PE pearl
- DN dune
- PL platinum
- PB lead
- NE black
- BO bordeaux
- AT anthracite
- SE mustard
- SI silica
- DO dolomite grey
- AL clay
- MK moka
- CM caramel
- CZ light blue grey
- SA sand
- RU ruby
- CI cadmium

Coloured etched glass

- BC chalk white
- PE pearl
- DN dune
- PL platinum
- PB lead
- NE black
- BO bordeaux
- AT anthracite
- SE mustard
- SI silica
- DO dolomite grey
- AL clay
- MK moka
- CM caramel
- CZ light blue grey
- SA sand
- RU ruby
- CI cadmium

DATASHEET

REGISTERED
DESIGN

IX.2015

TECHNICAL INFORMATION

SIDES, SHELVES TH. 28, BACKS

Chipboard covered with Oak (Quercus), Eucalyptus (Eucalyptus globulus) or melamine painted in colours from the Molteni range.

BASEBOARD

Anodised extruded aluminium painted in colours from the Molteni range or covered with Oak or Eucalyptus.

WOODEN DOORS TH. 22 AND EXTERNAL DRAWER FRONT TH. 22

Chipboard covered with Oak, Elm (Ulmus rubra), Eucalyptus or melamine painted in colours from the Molteni Range.

DOOR AND DRAWER FRONT TH. 40

Honeycomb core wood panel covered in Oak, Elm, Eucalyptus sliced wood veneer or melamine facing, painted in the colours of the Molteni Range.

BACKS FOR TV

Chipboard covered with Oak, Elm, Eucalyptus or melamine painted in colours from the Molteni range.

GLASS DOORS WITH SHAPED PROFILE

Anodised extruded aluminium frame. Toughened glass 5 mm thick, clear, coloured in colours from the Molteni Range.

GLASS DOORS AND GLASS DRAWER FRONT TH. 5

Chipboard covered with painted melamine with applied 5 mm thick tempered crystal painted in colours from the Molteni Range.

WOODEN TOP TH. 10

MDF covered with Oak, Elm, Eucalyptus sliced wood or melamine covered, painted in colours from the Molteni Range.

GLASS TOP

Tempered glass (th. 8 mm) with edge in extruded aluminium or tempered glass (th. 10 mm) painted in the colours of the Molteni Range.

INSIDE DRAWER BOTTOM AND SIDES

Chipboard covered with melamine.

HANDLES AND WIRE HOLE

In several materials and finishes available.

GLASS SHELVES

8 mm thick tempered clear crystal.

LADDER

Painted aluminium.

SLIDING DOOR TRACK, BRIDGE BAR

Anodised extruded aluminium (several finishes).

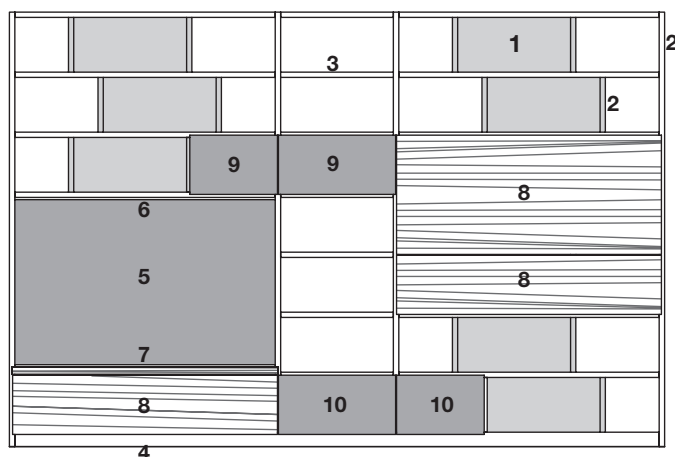

- 1 BACK
- 2 SIDE
- 3 SHELVES TH. 28
- 4 PLINTH OR SLIDING TRACK
- 5 TV BACK
- 6 BRIDGE BAR
- 7 TOP
- 8 DOORS TH. 40
- 9 DOORS TH. 22
- 10 EXTERNAL DRAWER

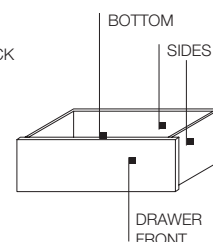

OPEN CORNER COMPOSITIONS

Internal corner

Features

In order to create the compositions shown here, the partitions (always in D 304 12") close to the connection, must be positioned as illustrated in options A and B.

To calculate the price of the plinths, please note that the length is the same as the base.

These corner compositions are only available in the depth of 400 (15 3/4").

The sections between the two compulsory central partitions cannot be closed by any kind of fronts and are always without back panels.

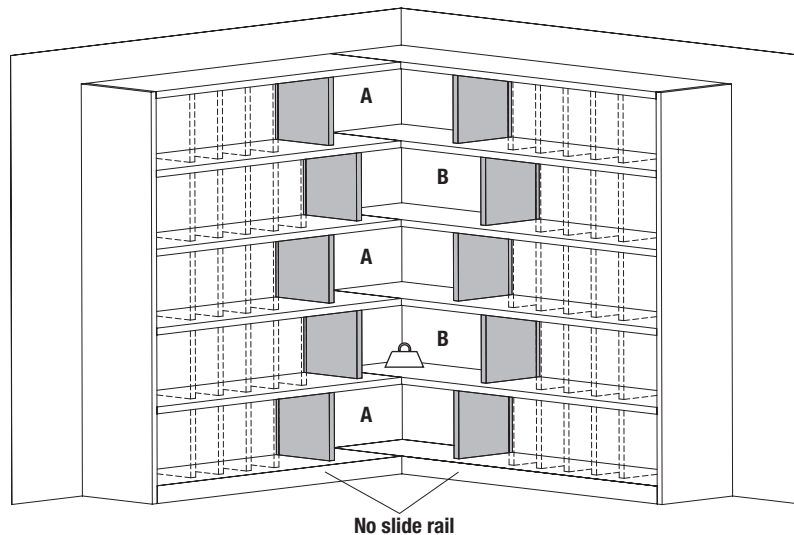

The section between the two mandatory central partitions has a load capacity of 10 Kg, evenly distributed

Molteni & C

External corner

Features

In order to create the compositions shown here, the partitions (always in D 304 12") close to the connection, must be positioned as illustrated in options A and B.

The price of one ZO/44 for completing the corner has to be added to the price of the plinths.

These corner compositions are only available in the depth of 400 (15 3/4").

The sections between the two compulsory central partitions cannot be closed by any kind of fronts and are always without back panels.

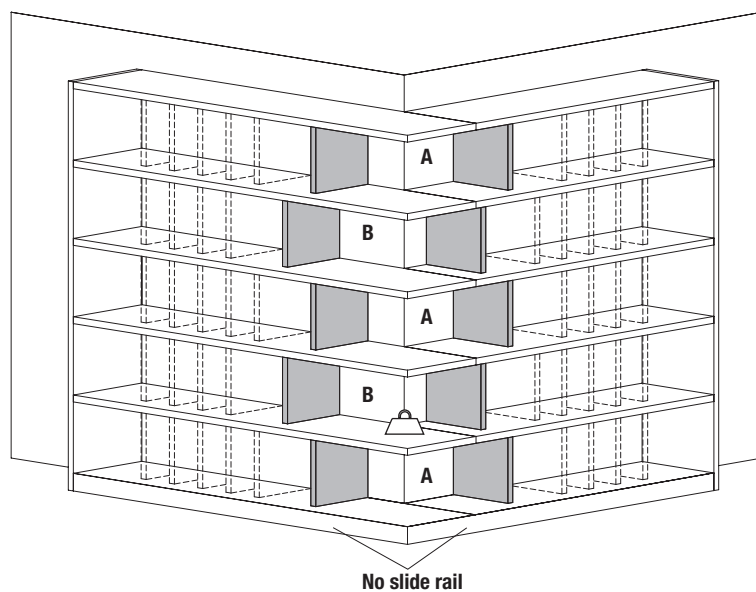

The section between the two mandatory central partitions has a load capacity of 10 Kg, evenly distributed

DATASHEET

REGISTERED
DESIGN

IX.2015

molteni.it

Dimensions in millimeters and inches. The right to discontinue and make changes is reserved. This information is based on the latest product information available at the time of printing.

INTERNAL DRAWER UNITS

For open compartments, sliding doors and glass hinged doors with shaped profile

The internal drawer units can be positioned between two shelves th. 28 mm (1 1/8") (example A) or between two tops with th. 10 mm (3/8") (example B). These 10 mm (3/8") tops are specific for these internal drawer units.

All drawers are always with pressure opening and always fully extractable.

If the compartments are open, or closed by a sliding door, the drawer unit is flush with the structure. When the internal drawer units are behind a glass hinged door they are recessed of 18 mm (3/4") and aligned with the internal shelves.

The compartment that holds the internal drawer unit must always have a back panel or a rear finishing panel.

Molteni & C

6—
15

Example A

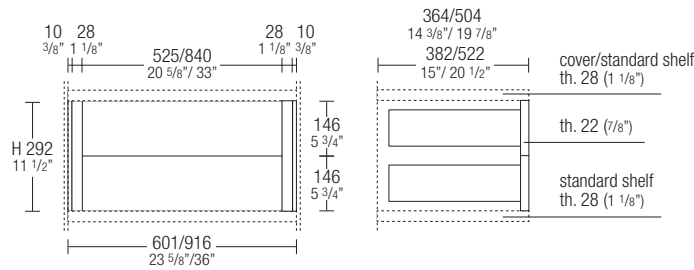

Example B

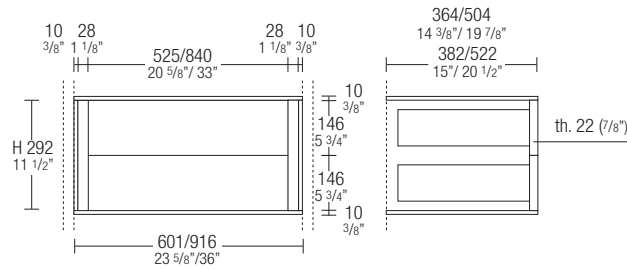

For compartments with wood hinged doors 22 mm (7/8") pressure opening or with handle

The internal drawer units are always positioned between two shelves th. 28 mm (1 1/8").

All drawers are always with pressure opening and always fully extractable.

The internal drawer units are recessed of 18 mm and aligned with the internal shelves.

The compartment that holds the internal drawer unit must always have a back panel or a rear finishing panel.

Example

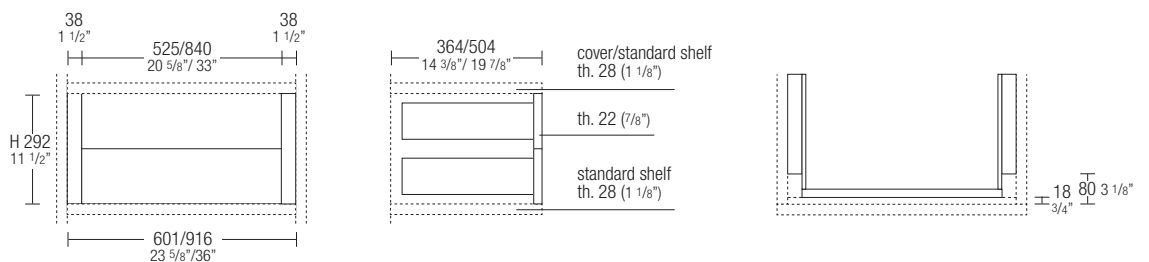

DATASHEET

REGISTERED
DESIGN

IX.2015

molteni.it

Dimensions in millimeters and inches. The right to discontinue and make changes is reserved. This information is based on the latest product information available at the time of printing.

BRIDGES

Bridges, available in various widths and depths of 304 and 400, can be composed with either a support bar or fixed to the wall.

Upper and lower shelves are always full size and the internal subdivision must be made based on the same building methods as for modules W 1260-1417-1890 (internal shelf max W 916 mm).

A bridge D 400 can also be subdivided internally by inserting components D 304.

Wall attachment

Wall attachment can be completed with an invisible mount system inserted in the central structural panels. A bridge with full-height central structural panels (see examples 1 and 2) requires a wall mount for each panel. A bridge with central structural panels for a H 1 module (see example 3) must be provided with a number of wall mounts distributed over the entire height of the bridge, privileging the lower part. The central structural panel with the wall mount must be accessible from above for adjustments, and therefore another panels cannot be placed on top of it. **The price of the wall mount must be added to the price of the central panels.**

Notes

For wall mounted assembly (examples 1/2) a space of at least 18 cm from the ceiling is required

Molteni&C

7—
15

Example 1

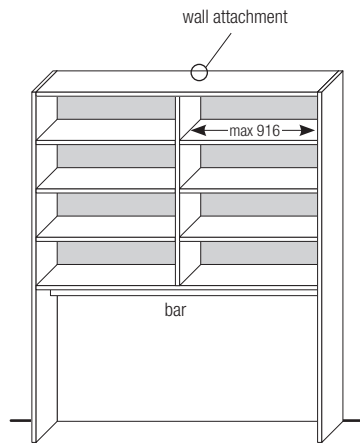

Example 2

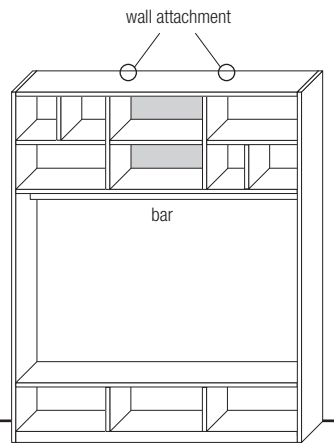

Example 3

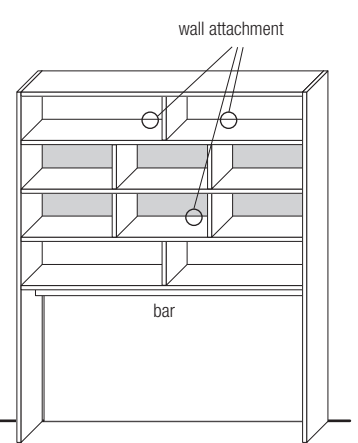

Wall attachment capacity

The wall mount system includes nylon toggle bolts. Wall attachment must be performed up to standard on walls (solid or perforated) suitable for mounting bolts. Molteni&C is not responsible for any attachments that do not comply with the aforementioned information. Upon request a chemical bolt kit is available as indicated on the previous page (minimum wall thickness of 100 mm). Max load per mount of 150 kg uniformly distributed.

Worktop D 400

Using the bridge bar and a specific back panel, the bridge shelves can be transformed into a desk or a TV shelf. The top and sides of adjacent lateral unit may be equipped with a wire hole. Covered with a back panel the bar is always in black lacquer. Above the bridge shelf a central finishing top can be added th. 40 in depths 446 or 586.

Desk use

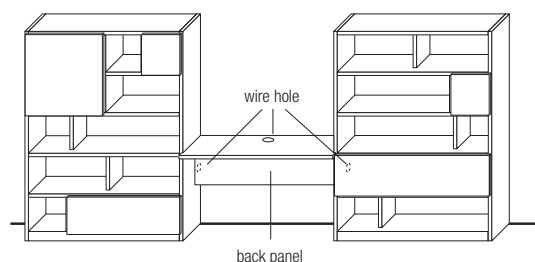

TV shelf

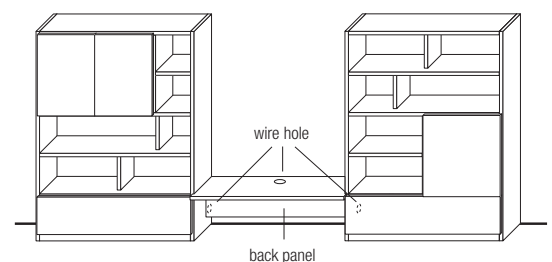

H-FI COMPARTMENT D 400

By using module widths of 1260-1417-1890 a Hi-Fi compartment can be created which can be closed by sliding door, or by flap door, or by flap door + vertical sliding door. The back of the Hi-Fi compartment is specifically equipped for suspended TV or standing TV. This back can be fixed or removed from the front part. The structural shelf closing the Hi-Fi compartment must have the bridge bar even if some wall mount are used.

The back is shorter than the Hi-Fi compartment height for the passage of cables, (see details A and B).

TV signal receiver

The \varnothing 18 sensor is always positioned in the lower part of the TV back. Specify right or left when ordering. IR bars can only be placed in a compartment adjacent or below the TV back (to be specified when ordering). The cost of a wire hole is not included. The bar can only be fixed to the structural panels.

Wire Hole

The Hi-Fi compartment may be connected using a wire hole to adjacent or lower compartments. The wire hole is located behind the TV back.

Molteni & C

8—
15

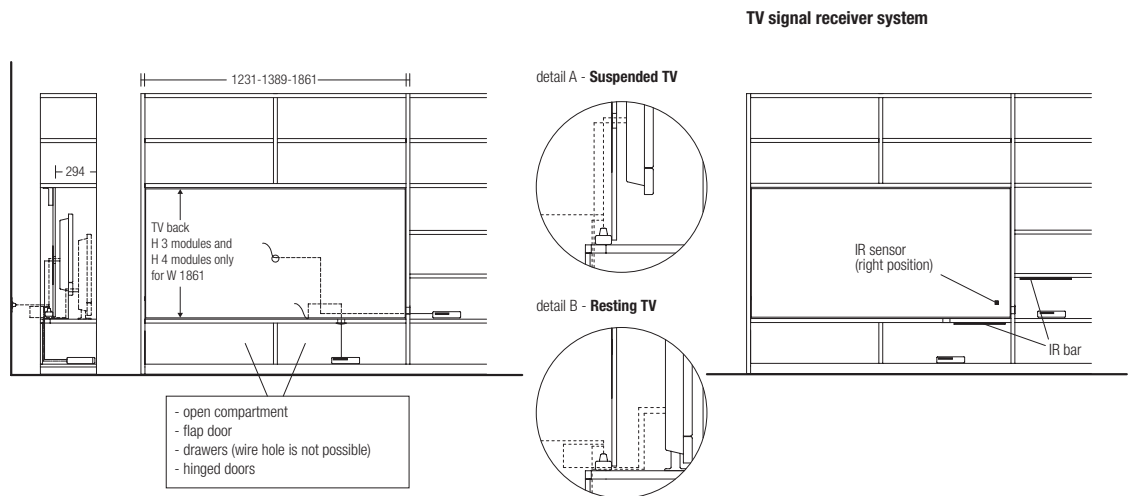

DATASHEET

REGISTERED
DESIGN

IX.2015

molteni.it

Dimensions in millimeters and inches. The right to discontinue and make changes is reserved. This information is based on the latest product information available at the time of printing.

TV COMPARTMENTS WITH SHELVES D 400

TV compartments can be created using module widths of 1260-1417-1890 and a height of 4 modules (1252 mm). These compartments can be equipped with glass shelves at the top or at the bottom. The TV can rest on a central shelf or a base, or be mounted to the back panel. The back panel can be fixed or removed from the front part. The unit follows the rules for bridge-style compositions: a bridge bar must be used. Only one glass shelf can be installed in each groove on the back panel. A rectangular wire passage is always provided in the position shown on the back panel.

No central finishing tops can be placed on these TV compartments. The shelves have a load capacity of 10 Kg, evenly distributed.

TV signal receiver

The ø 18 sensor is always positioned in the lower part of the TV back. Specify right or left when ordering. IR bars can only be placed in a compartment adjacent or below the TV back (to be specified when ordering). The cost of a wire passage is not included. The bar can only be fixed to the structural panels.

Wire passage

The TV compartment may be connected using a wire passage to adjacent or lower compartments. The wire passage is located behind the TV back.

Molteni & C

Examples of a TV compartment with shelves

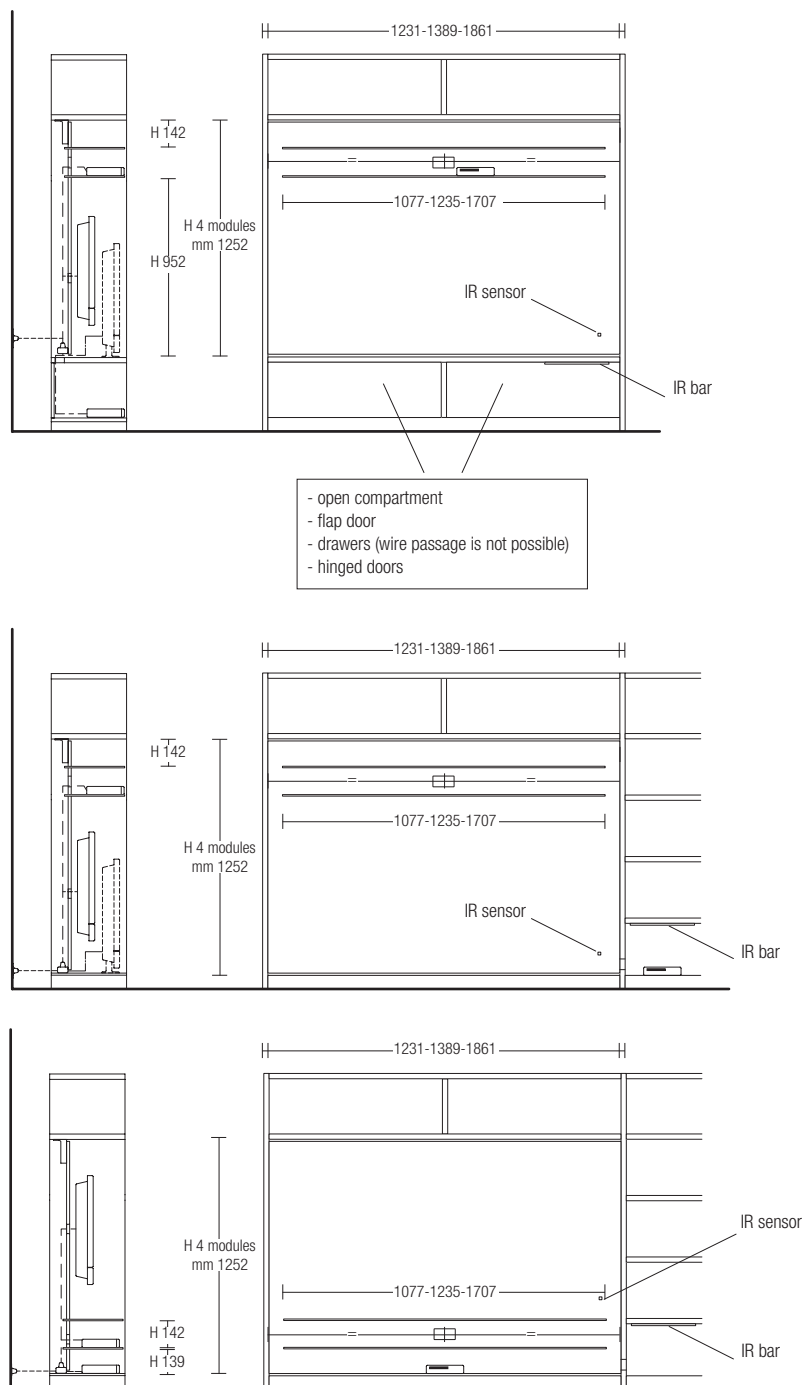

VERTICAL SLIDING DOORS TH 40

The units in 505 compositions W 1260-1417 can be closed with vertical sliding doors for H 2 modules. The upper and lower shelves must be structural shelves with interruption in the back. The central structural panels and internal shelves of the compartment are always D 304 mm to enable the sliding of the door. The subdivision of the central structural panels is according to the indicated rules. The vertical sliding door cannot be used in units D 304 mm. For the movement of the vertical sliding door, the upper 2 compartments must remain open. The vertical sliding mechanism is completely contained in the compartment for H 2 or H 3 modules if paired with a flap door. It is possible to compose a Hi-Fi compartment by using the vertical door together with the flap door (total H of 3 modules). The bridge bar and the TV back are to be added. Two vertical sliding doors cannot be placed side by side.

Notes

The price of the vertical sliding elements includes the tracks attached to the sides. Upon request, at no extra charge, the vertical sliding door can be created with a type "B" handle fixed centrally at the bottom.

* wood only with horizontal grain

Example of flap on base

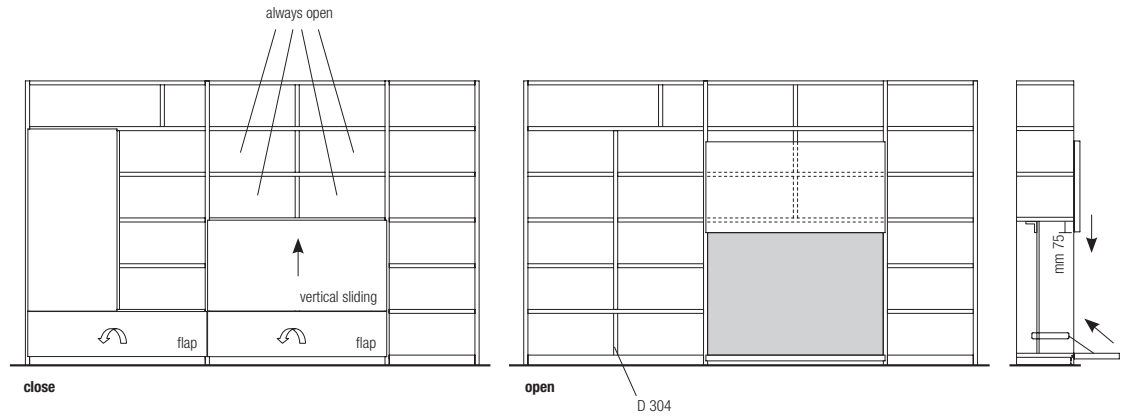

Example of flap door hinged to a structural shelf

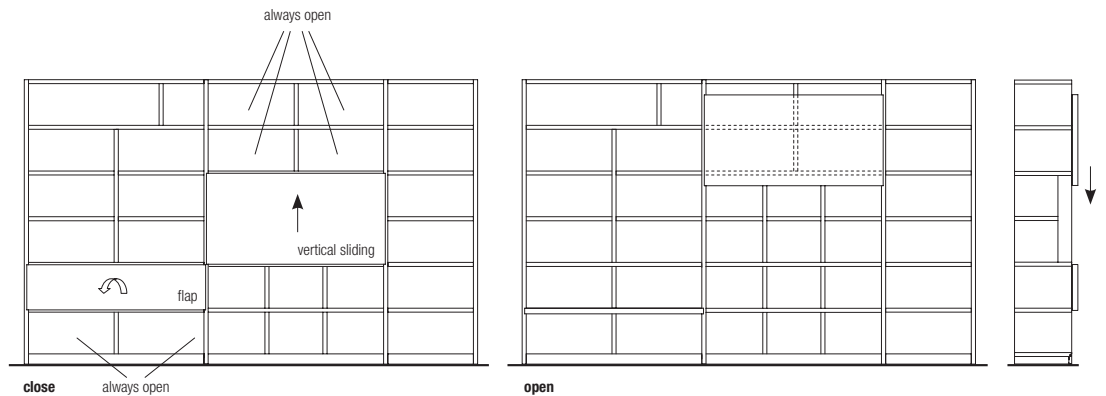

DOORS

pressure and sliding opening th 40

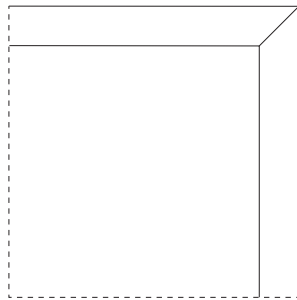

pressure opening th 22

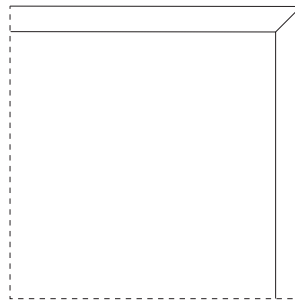

glass door with shaped profile

hinged and sliding doors

this handle is not available for external drawers

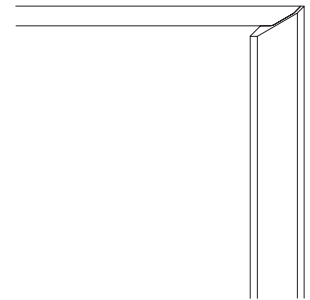

opening with the handle th 22

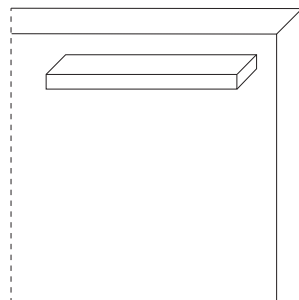

pressure opening glass th 5

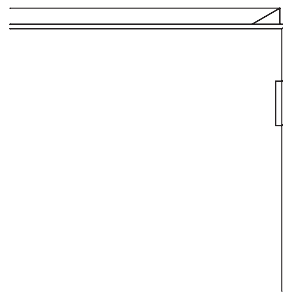

EXTERNAL DRAWERS

Standard version comes with partially extractable runners.
Fully extractable runners are available with a surcharge.

* wooden drawers only with horizontal grain

Notes

External drawers can be inserted into compartments with a height of 1 or 2 modules. A back panel of 16 mm th. and a pair of sides listed below must be added.

Drawers placed on the base

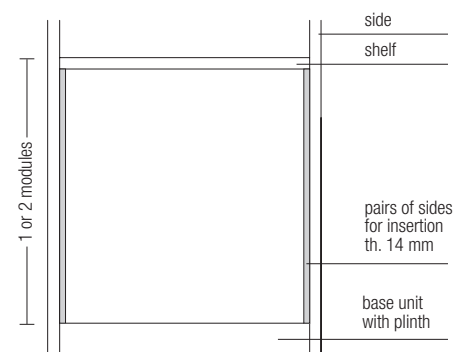

Drawers within the unit

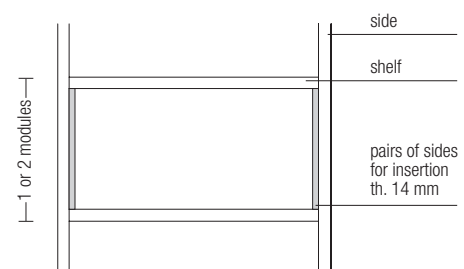

DATASHEET

REGISTERED
DESIGN

IX.2015

SAMPLE COMPOSITIONS

composition 1

finish: matt chalk white lacquer

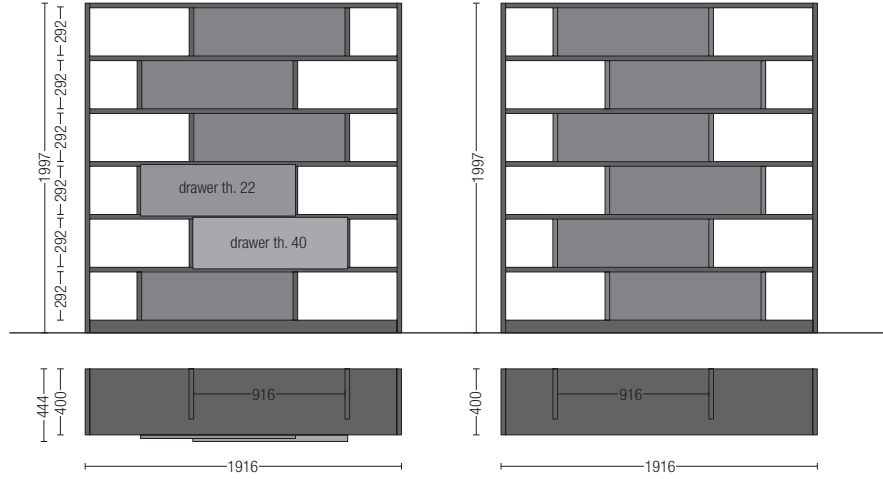

CDC01 (left comp.)

CDC01 (right comp.)

composition 2

finish: matt chalk white lacquer

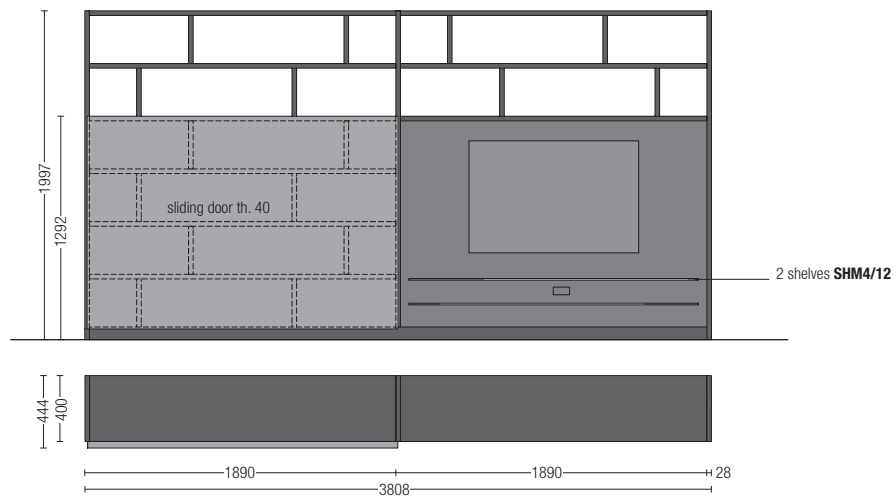

CDC02

DATASHEET

REGISTERED
DESIGN

IX.2015

SAMPLE COMPOSITIONS

composition 3

finish: matt chalk white lacquer

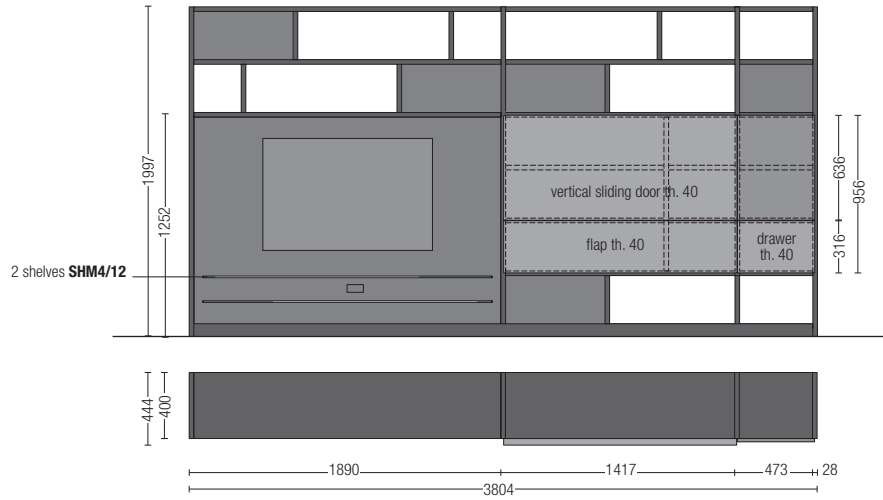

CDC03

composition 4

finish: matt chalk white lacquer



CDC04

Molteni & C

13 —
15

DATASHEET

REGISTERED
DESIGN

IX.2015

molteni.it

Dimensions in millimeters and inches. The right to discontinue and make changes is reserved. This information is based on the latest product information available at the time of printing.

SAMPLE COMPOSITIONS

composition 5

finish: matt chalk white lacquer
doors in transparent glass with shiny aluminium profile

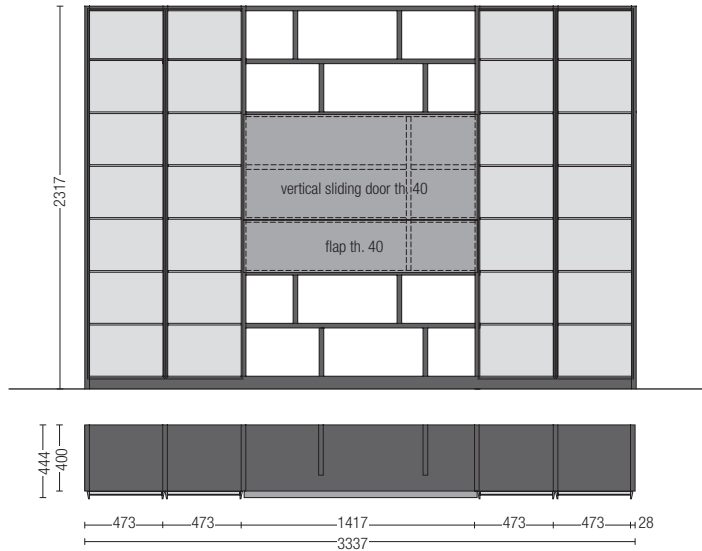

Molteni & C

14 —
15

CDC05

composition 6

finish: matt chalk white lacquer
sliding door in coloured glass with shiny aluminium profile

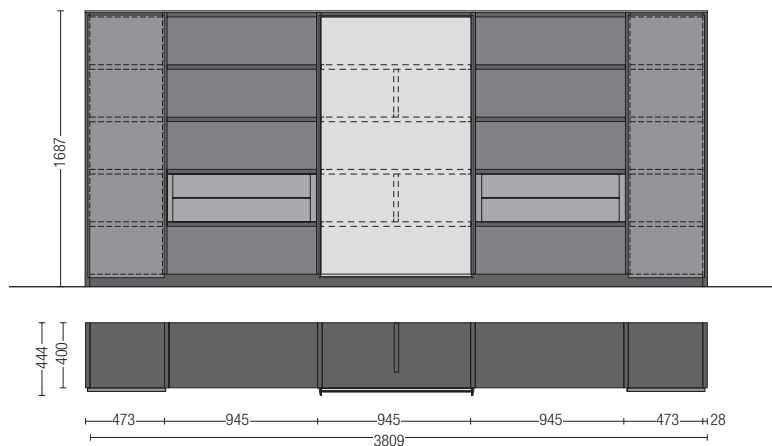

CDC06

DATASHEET

REGISTERED
DESIGN

IX.2015

molteni.it

Dimensions in millimeters and inches. The right to discontinue and make changes is reserved. This information is based on the latest product information available at the time of printing.

SAMPLE COMPOSITIONS

Molteni & C

15 —
15

composition 7

finish: matt chalk white lacquer
doors in transparent glass with shiny aluminium profile.

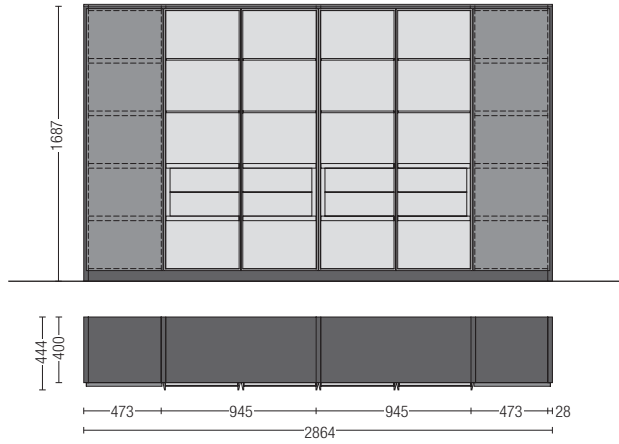

CDC07

composition 8

finish: matt chalk white lacquer

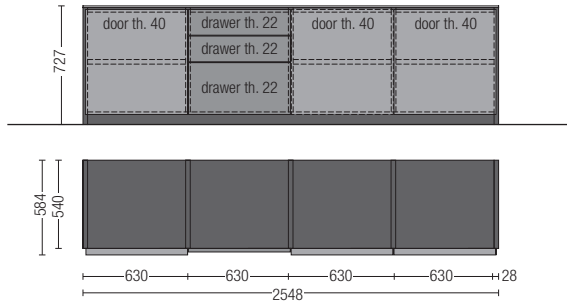

CDC08

composition 9

finish: matt chalk white lacquer

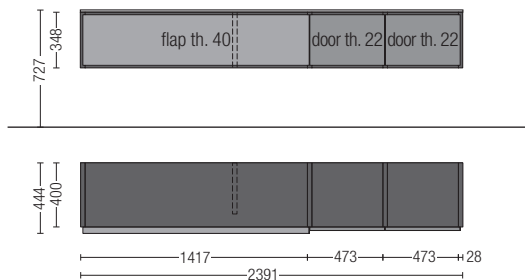

CDC09

DATASHEET

REGISTERED
DESIGN

IX.2015

molteni.it

Dimensions in millimeters and inches. The right to discontinue and make changes is reserved. This information is based on the latest product information available at the time of printing.

FINISHES MOLTENI&C RANGE

IX.2015

	MATT LACQUER OPEN GRAIN LACQUER	GLOSSY LACQUER	COLOURED GLASS	ETCHED COLOURED GLASS	PLASTER LACQUERED CARTAPAGLIA LACQUERED <i>only Gliss Master</i>
CHALK WHITE	•	•	•	•	•
IVORY	•				•
PEARL	•	•	•	•	•
SILICA	•	•	•	•	•
SAND	•	•	•	•	•
PLATINUM	•	•	•	•	•
DUNE	•	•	•	•	•
CLAY	•	•	•	•	•
DOLOMITE GREY	•	•	•	•	•
BORDEAUX	•	•	•	•	•
RUBY	•	•	•	•	•
CARAMEL	•	•	•	•	•
MOKA	•	•	•	•	•
MUSTARD	•	•	•	•	•
CADMIUM	•	•	•	•	•
LIGHT BLUE GREY	•	•	•	•	•
LEAD	•	•	•	•	•
ANTHRACITE	•	•	•	•	•
BLACK	•	•	•	•	•
LESSLESS RED	•				
only matt lacquer					

Molteni & C

FINISHES MOLTENI&C RANGE

IX.2015

WOODS

EUCALYPTUS

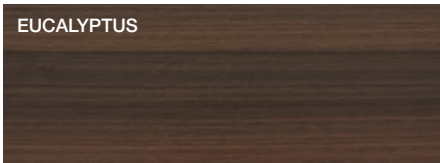

AMERICAN WALNUT



GREY OAK



BLACK OAK



DARK ELM



LIGHT ELM



CEDAR



MARBLES

WHITE CARRARA

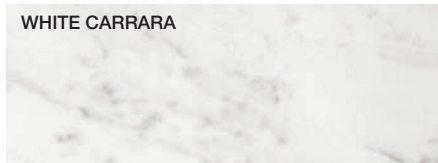

RED LAGUNA



EMPERADOR DARK

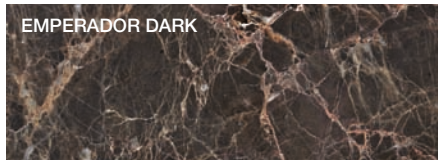

BLACK MARQUINA

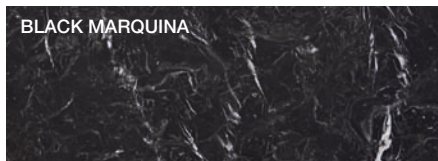

GRES

WHITE

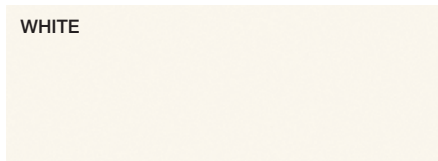

ANTHRACITE



METAL PARTS

BLACK CHROME

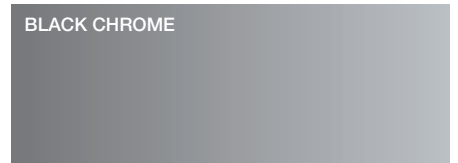

SHINY ALUMINIUM

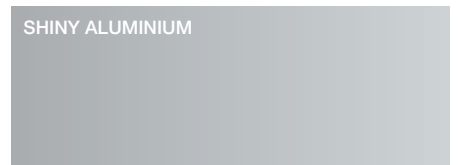

PEWTER COLOUR

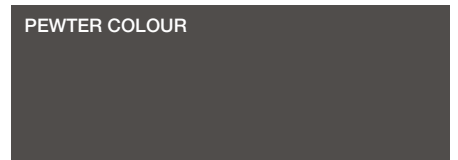

DWELL
DOOR FRAME, TRACK COVERING PROFILES

ANODISED ALUMINIUM



BROWN ALUMINIUM

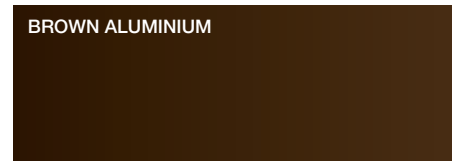

The finishes shown are indicative and refer to the entire production range. We recommend that you consult the "Colour Range" samples which shown the complete range of finishes, including those not shown here. Molteni&C reserves the right to modify the range without warning.

FINISHES MOLTENI&C RANGE

IX.2015

MILLERIGHE
GLISS QUICK FRONT

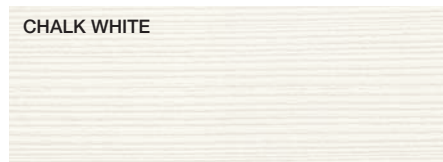

CARTAPAGLIA
GLISS MASTER FRONT
GLISS QUICK, GLISS WALK-IN FRONT

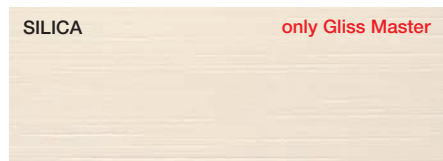

MILLERIGHE
GLISS QUICK, GLISS-UP STRUCTURE

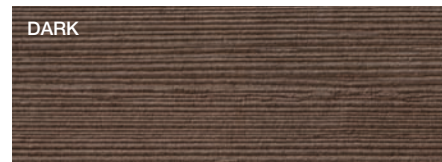
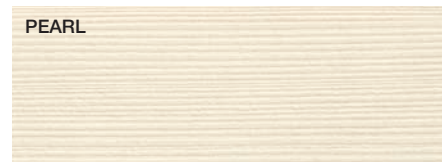

ECO SKIN only Gliss Master

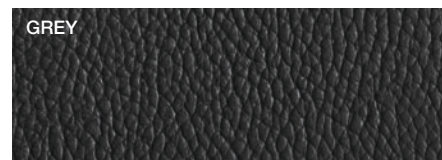

PLASTER only Gliss Master

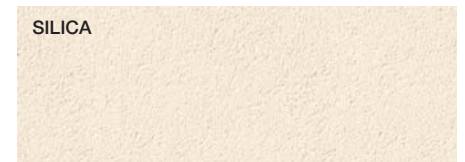

MELAMINE STRUCTURE only Gliss Master

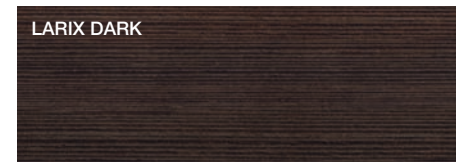
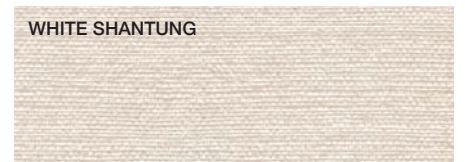

Larix dark finish available also for Gliss Walk-In where specifically indicated in the pricelist