



MA1003-MA1001-MA1061

ITA

Struttura Sedile in poliuretano espanso ignifugo indeformabile a densità differenziate e fibra poliestere con struttura interna in legno. Schienale e braccioli in espanso schiumato a freddo ignifugo. Le poltrone cod.001 e 061 sono in espanso schiumato a freddo ignifugo con struttura interna in acciaio. I piedini avvitati alla struttura sono in polipropilene nero.

Rivestimenti I tessuti della collezione M.A.S.S.A.S sono accoppiati a fibra poliestere e poliuretano per dare speciale sostegno e corpo al rivestimento. - Tessuto cliente cat. H; lana (Remix, Canvas e Land) cat. S; panno Divina MD cat. W.

- A richiesta e previa autorizzazione, possibilità di accoppiare tessuti non presenti in tirella Surfaces for M.A.S.S.A.S. 117 e tessuti cliente con un metraggio minimo di 20 metri lineari.

I prezzi indicati a listino si riferiscono agli elementi rivestiti con i tessuti accoppiati presenti nella tirella Surfaces for M.a.s.s.a.s n.117.

L'utilizzo dei tessuti: Uniforms (tirella Units 3 n.120) e elastici 3d prevede una riduzione di prezzo del 8%.

Caratteristiche La collezione M.A.S.S.A.S. è sfoderabile.

Attenzione I disegni delle composizioni si riferiscono alla versione destra. Consegna 6 settimane. Gli elementi cod. E50 - E51 - E56 - E57 e il divano cod.003 sono provvisti di tasche laterali.

DEU

Struktur Sitzkorpus aus feuerhemmend Polyurethanschaumstoff in verschiedenen Raumgewichte auf Holzgestell.

Arm- und Rueckenlehne, Kaltschaum gespritzt auf Stahlgestell. Der Sessels Kode 001 und 061 in Kaltschaum feuerhemmend, mit Innenstruktur aus Stahl. Fuesse aus Polypropilen schwarz.

Bezug Stoffe Kollektion M.A.S.S.A.S sind mit Polyester-Faser und Polyurethan gekoppelt um besondere Unterstützung und Körper dem Bezug zu geben.

- Kundenstoff cat.H; Baumwollsatın cat. S; Wolle (Remix und Canvas) cat. S; Wolle (Divina - Units 3) cat. W.

- Auf Anfrage und nach ausdrücklicher Annahme, können Stoffe, die nicht im Bügel Surfaces for M.A.S.S.A.S 117 enthalten sind, in einer Mindestmenge von 20 Meter gekoppelt werden.

Die in der Preisliste angegebene Preise beziehen sich auf Produkte mit gekoppelten Textilien abgedeckt in Bügel Surfaces for M.a.s.s.a.s n.117. Die Verwendung von Stoffen: Uniforms (Bügel Units 3 n.120) und elastische 3d sieht eine Verringerung des Preises um 8%.

Besonderheiten Die Kollektion M.A.S.S.A.S. ist abziehbar.

Achtung Zeichnungen zeigen die Rechtsausführung. Lieferzeit 6 Wochen. Die Elemente cod. E50 - E51 - E56 - E57 und das Sofa cod.003 sind mit Seitentaschen versehen.

ENG

Structure Seat in polyurethane flame-retardant foam of different densities on wood frame.Arm- and backrest in injected flame-retardant foam on steelframe. The armchairs code 001 and 061 are in injected flame-retardant foam over internal steel frame. Feet in black polypropylene.

Covers Fabrics collection M.A.S.S.A.S are coupled with polyester fiber and polyurethane to give special support and body to the cover.

- Customer's own fabric cat.H; - wool (Remix, Canvas and Land) cat. S; wool Divina MD cat. W.

- On demand and only after our approval, fabrics not included in hanger Surfaces for M.A.S.S.A.S 117 and COM fabrics can be padded with a minimum quantity of 20 linea meters.

The price listed in the price list refer to items covered with coupled textiles in the hanger Surfaces for M.a.s.s.a.s n.117.

The use of fabrics: Uniforms (hanger Units 3 n.120) and elastic 3d provides for a reduction in price by 8%.

Features The M.A.S.S.A.S. collection has removable covers.

Note The drawings of the compositions refer to the right-hand version. 6 weeks delivery. The elements cod. E50 - E51 - E56 - E57 and the sofa cod.003 are provided with side pockets.

FRA

Structure Assise en mousse de polyuréthane ignifugée indéformable à densité variable et fibre polyester avec structure interne en bois.

Dossiers et accoudoirs en mousse ignifugée injectée à froid. Les fauteuils cod.001 et 061 sont en mousse ignifugée injectée à froid, avec structure interne en acier. Les pieds sont vissés à la structure en polypropylène noir.

Revêtements Les tissus de la collection M.A.S.S.A.S sont couplé avec fibre polyester et polyurethane pour accorder un soutien particulier au corps et revêtement.

- Tissu client cat.H; laine (Remix, Canvas et Land) cat. S; laine (Divina MDcat. W.

- Sur demande et seulement après notre bon pour accord, des tissus non inclus dans la liasse Surfaces for M.A.S.S.A.S 117 et des tissus clients pourront être matelassés avec une quantité minimum de 20 mètres linéaires.

Le prix indiqué dans la liste de prix se réfèrent à des éléments recouverts de textiles couplé dans le liasse Surfaces Tirella for M.a.s.s.a.n. 117.

L'utilisation de tissus: Uniforms (liasse Units 3 n. 120) et 3d élastique prévoit une réduction de prix de 8%

Caractéristiques La collection M.A.S.S.A.S. est déhoussable.

Attention Les dessins des compositions se réfèrent à la version droite. Livraison 6 semaines. Les éléments cod. E50 - E51 - E56 - E57 et le canapé cod.003 viennent avec des poches latérales.

RIVESTIMENTI CONSIGLIATI

Recommended fabric hangers
Vorgeschlagene Stoffbuegel
Liasses de tissus conseillées

117-Surfaces for M.A.S.S.A.S

-Uniforms

Elemento sinistro 157

Element left 157 - Element links 157 - Element gauche 157

7 mt. 1,2 m³ 70 Kg

E50

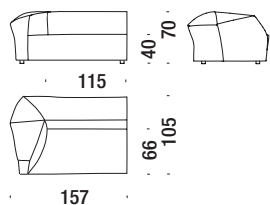

Elemento destro 157

Element right 157 - Element rechts 157 - Element droit 157

7 mt. 1,2 m³ 70 Kg

E51

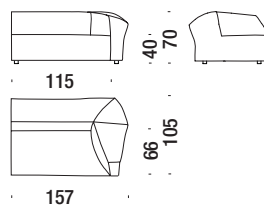

Elemento sinistro 187

Element left 187 - Element links 187 - Element gauche 187

8 mt. 1,4 m³ 85 Kg

E56

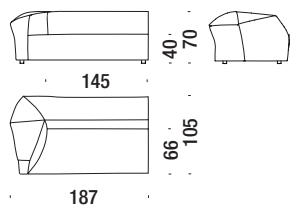

Elemento destro 187

Element right 187 - Element rechts 187 - Element droit 187

8 mt. 1,4 m³ 85 Kg

E57

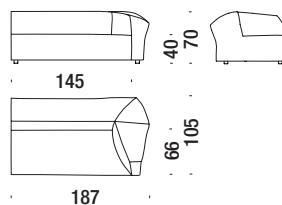

Elemento penisola sinistra 180

Element peninsula left 180 - Element Halbinsel links 180 - Element péninsule gauche 180

6,3 mt. 1,4 m³ 80 Kg

E52

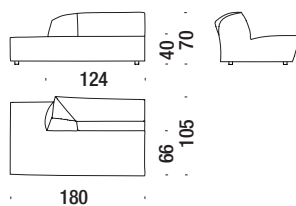

Elemento penisola destra 180

Element peninsula right 180 - Element Halbinsel rechts 180 - Element péninsule droit 180

6,3 mt. 1,4 m³ 80 Kg

E53

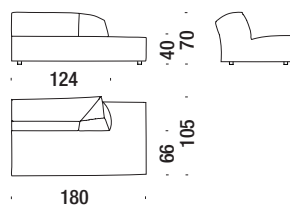

Angolo sinistro 220

Left corner 220 - Ecke links 220 - Angle gauche 220

9 mt. 1,7 m³ 100 Kg

E54

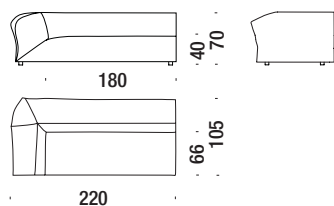

Angolo destro 220

Right corner 220 - Ecke rechts 220 - Angle droit 220

9 mt. 1,7 m³ 100 Kg

E55

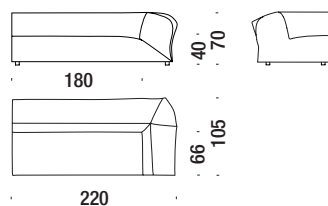

Chaise Longue sinistra

Chaise Longue left - Chaise Longue links - Chaise Longue gauche

6,6 mt. 1,4 m³ 70 Kg

OD4

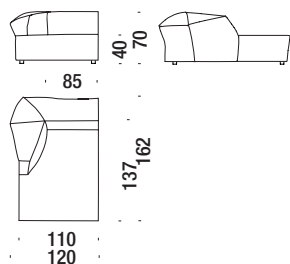

Chaise Longue destra

Chaise Longue right - Chaise Longue rechts - Chaise Longue droit

6,6 mt. 1,4 m³ 70 Kg

OD3

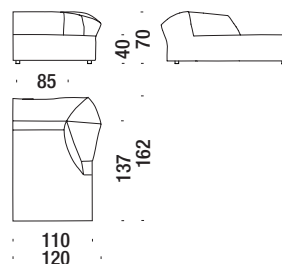

Elemento 1 posto centrale

1 seater element - Zentralelement - Élément central

5,7 mt. 1 m³ 45 Kg

011

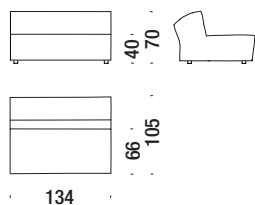

Pouf

Stool - Hocker - Pouf

3 mt. 0,6 m³ 20 Kg

017

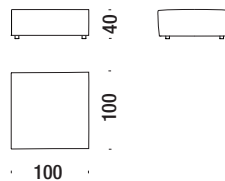

Poltroncina

Small armchair - Sessel Klein - Petit fauteuil

3,7 mt. 0,5 m³ 25 Kg

061

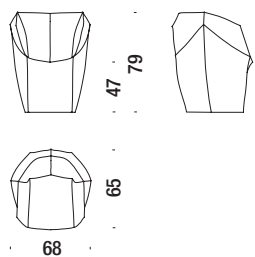

Poltrona

Armchair - Sessel - Fauteil

4,4 mt. 0,6 m³ 30 Kg

001

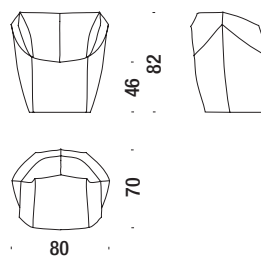

Divano 245

Sofa 245 - Sofa 245 - Canapé 245

9,2 mt. 2 m³ 120 Kg

003

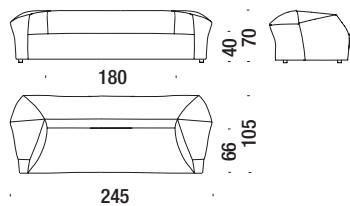

Composizione A10

Composition A10 - Zusammenstellung A10 - Composition A10

2,4 m³ 140 Kg

A10

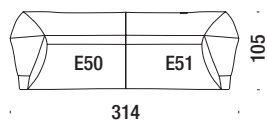

Composizione A20Dx-A20Sx

Composition A20R or A20L - Zusammenstellung A20R oder A20L - Composition A20D ou A20G

2,6 m³ 150 Kg

A20

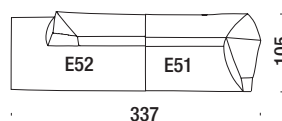

Composizione A30Dx-A30Sx

Composition A30R or A30L - Zusammenstellung A30R oder A30L - Composition A30D ou A30G

2,8 m³ 155 Kg

A30

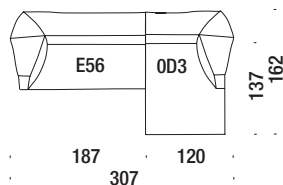

Composizione A40

Composition A40 - Zusammenstellung A40 - Composition A40

2,8 m³ 140 Kg

A40

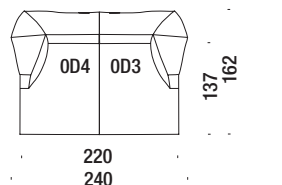

Composizione A50Dx-A50Sx

Composition A50R or A50L - Zusammenstellung A50R oder A50L - Composition A50D ou A50G

2,8 m³ 150 Kg

A50

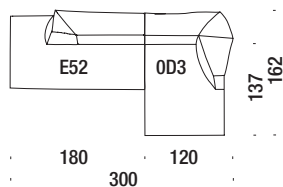

Composizione B10Dx-B10Sx

Composition B10R or B10L - Zusammenstellung B10R oder B10L - Composition B10D ou B10G

3,6 m³ 185 Kg

B10

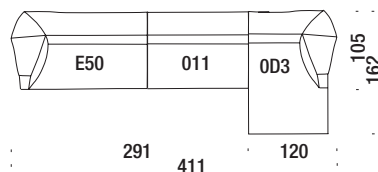

Composizione B20Dx-B20Sx

Composition B20R or B20L - Zusammenstellung B20R oder B20L - Composition B20D ou B20G

3,4 m³ 170 Kg

B20

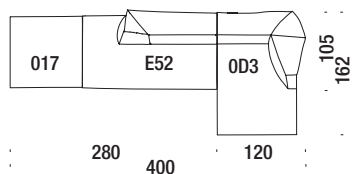

Composizione B30Dx-B30Sx

Composition B30R or B30L - Zusammenstellung B30R oder B30L - Composition B30D ou B30G

3,8 m³ 195 Kg

B30

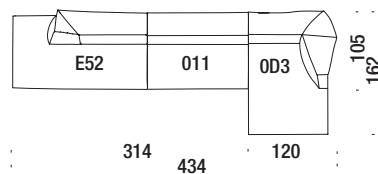

Composizione C10Dx-C10Sx

C10

Composition C10R or C10L - Zusammenstellung C10R or C10L - Composition C10D ou C10G

4,3 m³ 240 Kg

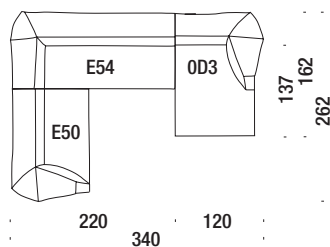

Composizione C20Dx-C20Sx

C20

Composition C20R or C20L - Zusammenstellung C20R or C20L - Composition C20D ou C20G

4,5 m³ 255 Kg

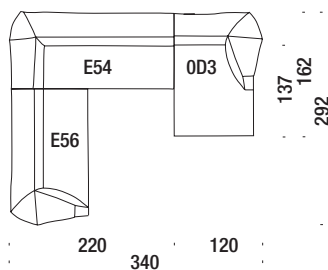

Composizione C30Dx-C30Sx

C30

Composition C30R or C30L - Zusammenstellung C30R or C30L - Composition C30D ou C30G

4,5 m³ 250 Kg

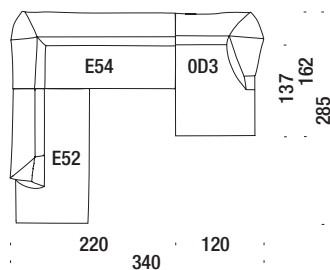

Composizione C40Dx-C40Sx

C40

Composition C40R or C40L - Zusammenstellung C40R or C40L - Composition C40D ou C40G

4,1 m³ 240 Kg

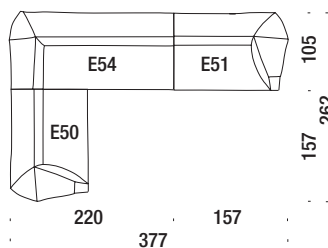

Composizione C50Dx-C50Sx

C50

Composition C50R or C50L - Zusammenstellung C50R or C50L - Composition C50D ou C50G

4,3 m³ 255 Kg

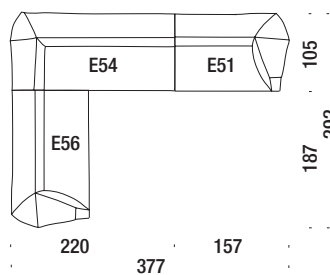

Composizione C60Dx-C60Sx

C60

Composition C60R or C60L - Zusammenstellung C60R or C60L - Composition C60D ou C60G

4,3 m³ 250 Kg

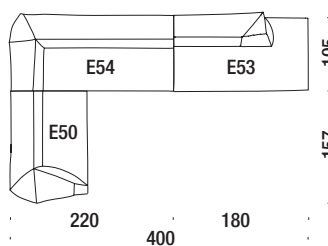

Composizione D10Dx-D10Sx

D10

Composition D10R or D10L - Zusammenstellung D10R or D10L - Composition D10D ou D10G

6 m³ 350 Kg

